

# viba<sup>®</sup>brush

# viba<sup>®</sup>brush

## Home test instructions



**Rovers Medical Devices B.V.**  
Lekstraat 10, 5347 KV Oss  
The Netherlands  
T +31 (0)412 648 870  
info@roversmedicaldevices.com  
www.roversmedicaldevices.com

Rovers<sup>®</sup> Viba-Brush<sup>®</sup> is a patented product and registered design.

Rovers<sup>®</sup> and Viba-Brush<sup>®</sup> are registered trademarks of Rovers Medical Devices B.V. Oss, The Netherlands.



REF 380200331  
VRM-2021-03-EN

# viba<sup>®</sup>brush

The Rovers Viba-Brush allows you to perform a comfortable, hygienic home test for the early detection of cervical cancer. The Viba-Brush enables you to easily collect cell material from your vagina. This cell material can then be analysed in a professional laboratory.

## What you need to know beforehand:

- Intended for single use.
- Reuse results in contamination and an incorrect diagnosis.
- Do not use if the Viba-Brush packaging has been damaged or if it is past the expiration date.
- Do not use during menstruation.
- Do not use during pregnancy, if you suspect you are pregnant, or within three months following pregnancy.
- Discontinue the use of vaginal products at least 2 days before using the Viba-Brush. You can continue to use contraceptive vaginal rings, condoms and water-based lubricants.

## What does the home test look like?

The Rovers Viba-Brush is 20 centimetres long and consists of a pink handle and white brush for the self-sampling of cell material from the vagina.



White brush with flexible bristles

## The home test consists of:

1. Viba-Brush
2. ReMover
3. A plastic bag containing a white absorption pad
4. A return envelope



## You carry the test out as follows:



1 Wash your hands before beginning.

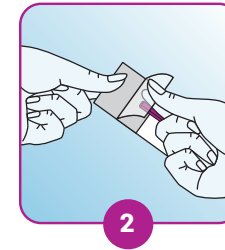

2 Open the packaging at the base of the handle. Grip the handle and slide the Viba-Brush out of the packaging.

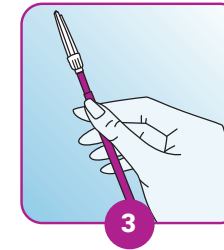

3 Hold the Viba-Brush securely in your hand, making sure not to touch the white brush.



4 Assume a comfortable position (such as when you insert a tampon).

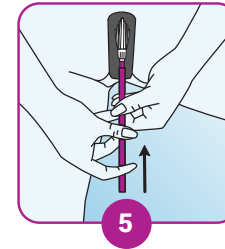

5 Insert the Viba-Brush as far as possible until you feel a painless resistance (at least 5 cm deep).

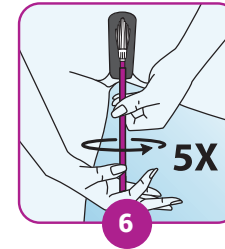

6 Rotate the Viba-Brush 360 degrees 5 times.

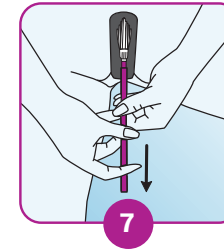

7 Slide the Viba-Brush out of the vagina.

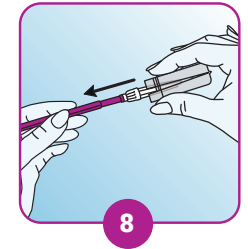

8 Slide the ReMover over the Viba-Brush as far as the brush will go and squeeze the ReMover firmly shut.

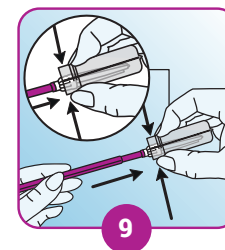

9 Use the ReMover to detach the white brush from the pink handle. Continue to keep the ReMover firmly squeezed shut. The pink handle can be discarded.

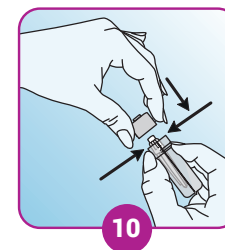

10 Place the supplied cap over the open end of the ReMover. Check that the cap is securely in place.

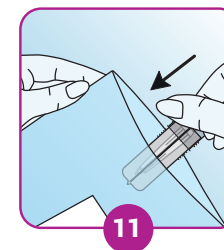

11 Place the ReMover in the plastic bag provided and seal it. Use the return envelope to send the plastic bag.